

L-416

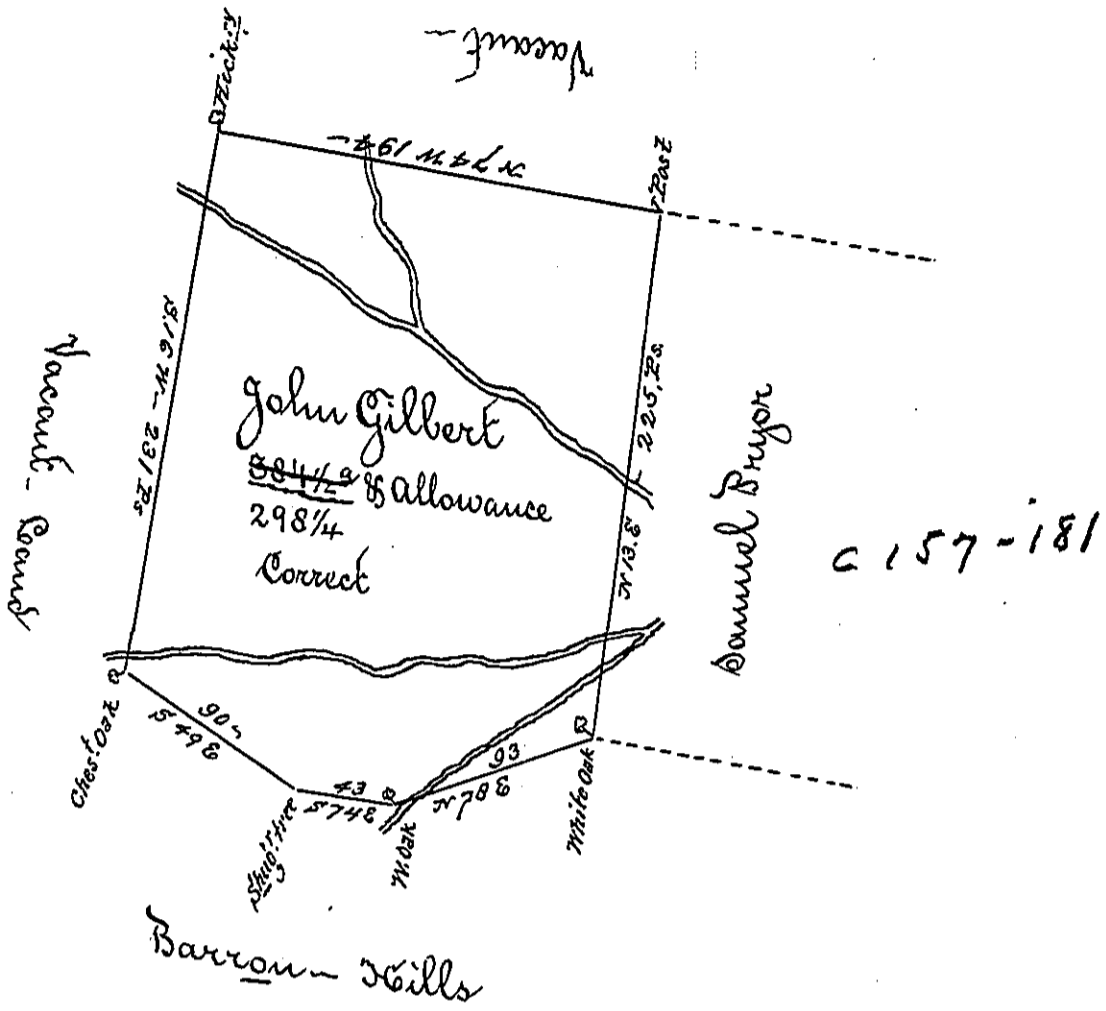

A Draught of a Tract of Land situate on a Branch which Leads into the South West Branch of the Drakes Town Branch of Juniata in the County of Cumberland, Containing ^{Two} ~~Three~~ Hundred ninety eight and ~~one~~ ^{Quarter} acres and one ~~half~~ ^{Quarter} and the usual allowance of six acres &c. for Roads &c. Surveyed the 15th Day of October 1766 for John Gilbert in Pursuance of a Warrant Dated the first Day of August 1766

To John Cook Esq:
Surveyor General

R. Richard Esq. Dep^y Surveyor

IN TESTIMONY that the above is a copy of the original remaining on file in the Department of Internal Affairs of Pennsylvania, made conformably to an Act of Assembly approved the 16th day of February, 1833, I have hereunto set my Hand and caused the Seal of said Department to be affixed at Harrisburg, this first day of November 1898

James W. Latta
Secretary of Internal Affairs.